

Application No: DC/20/01036

**Address: Ashes Farm, Newton
Road, Stowmarket, Suffolk,
IP14 5AD**

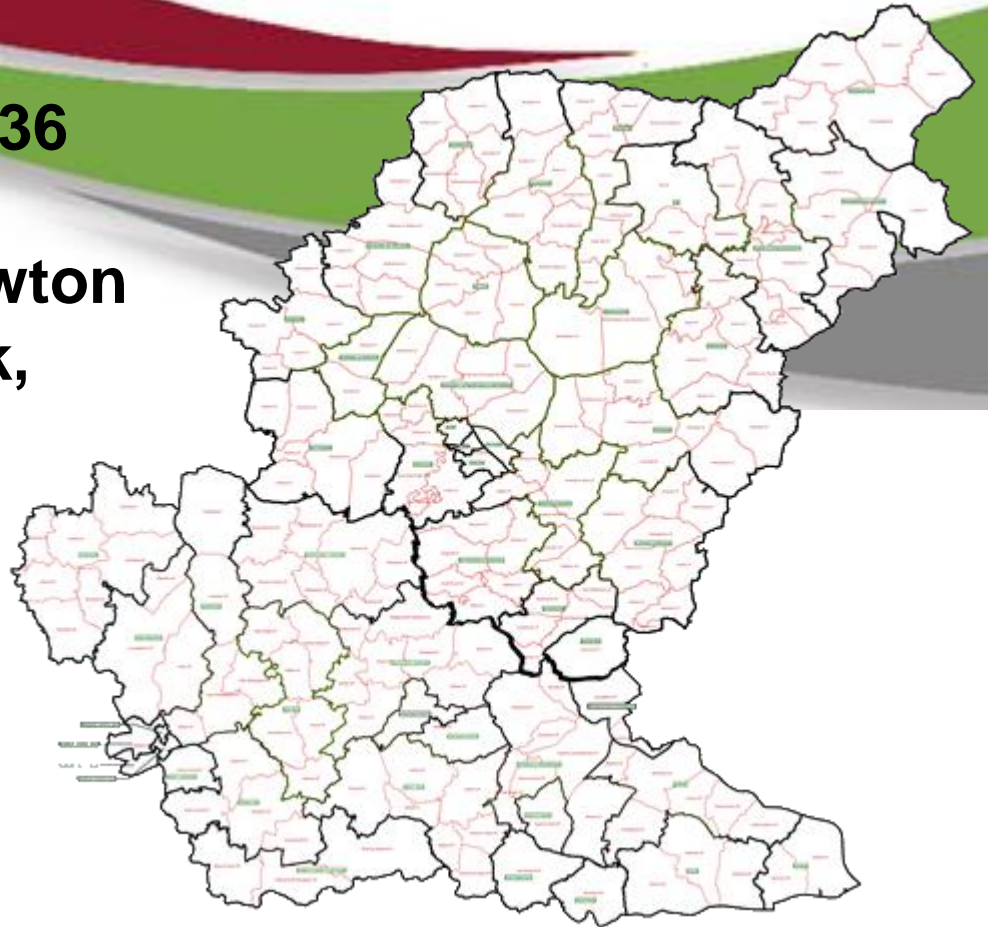

Aerial Map – wider view

Slide 2



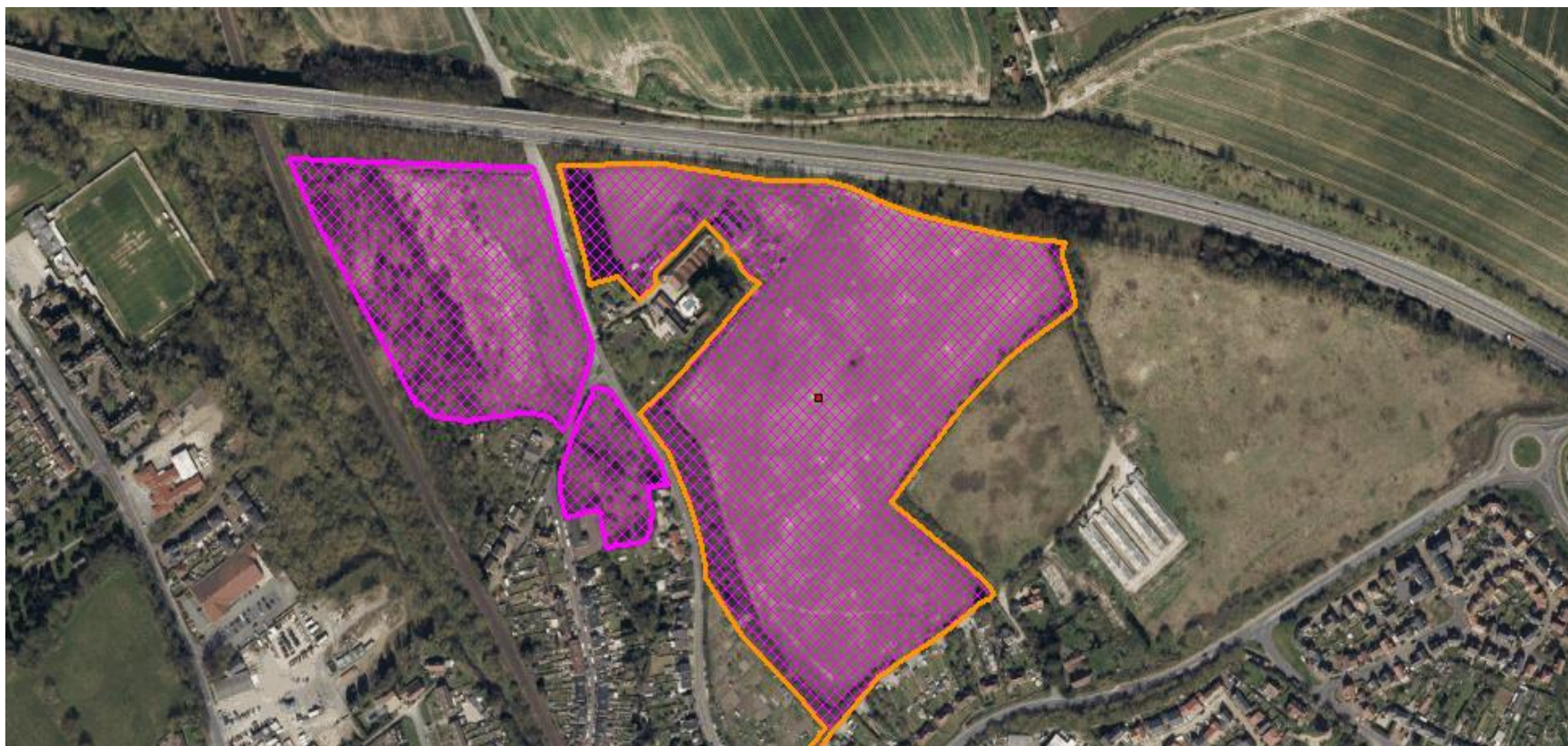



Public Rights of Way

..... Footpath



Flood Zone 2

Flood Zone 3



Built Up Area Boundaries

Listed Buildings



Grade II

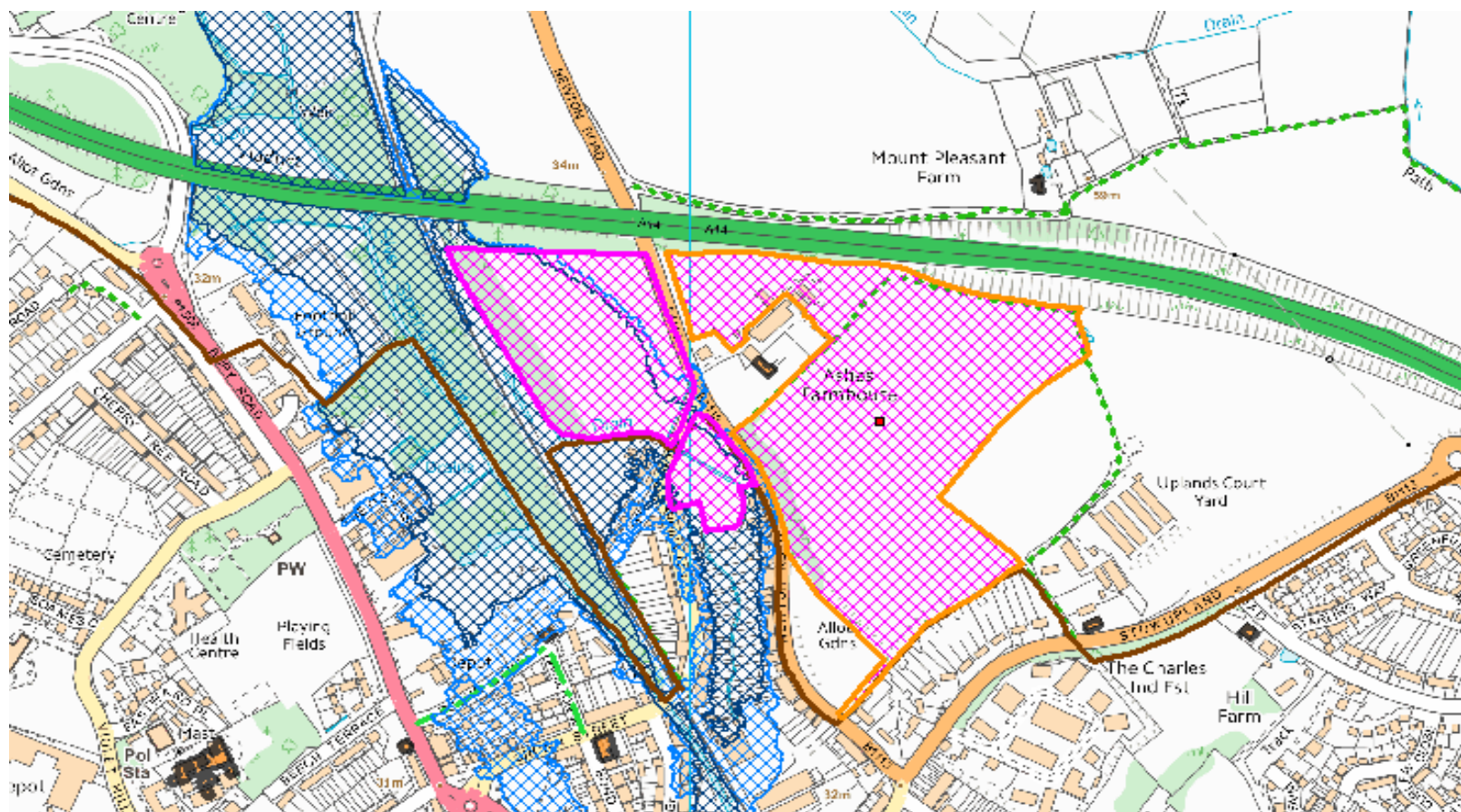

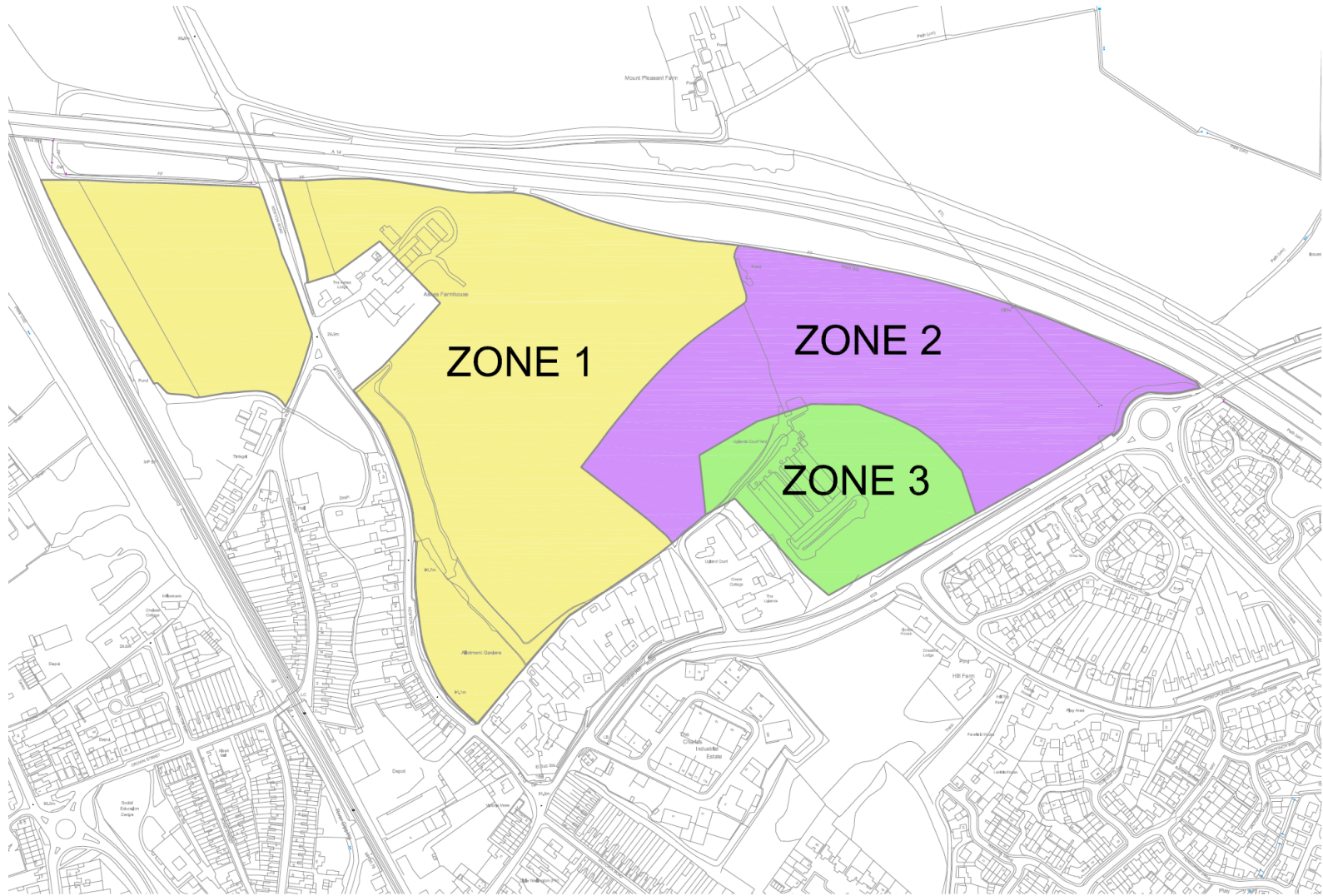

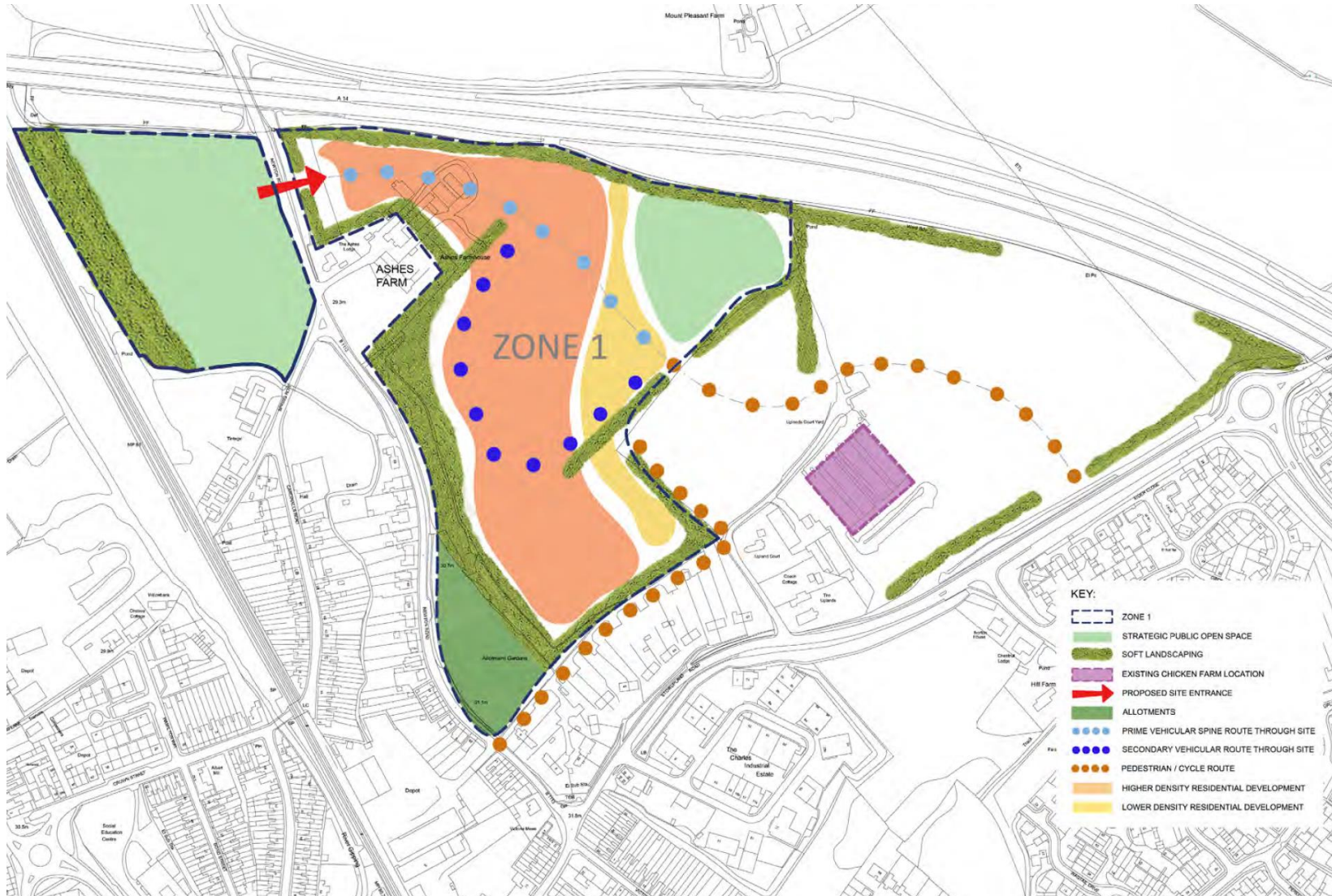



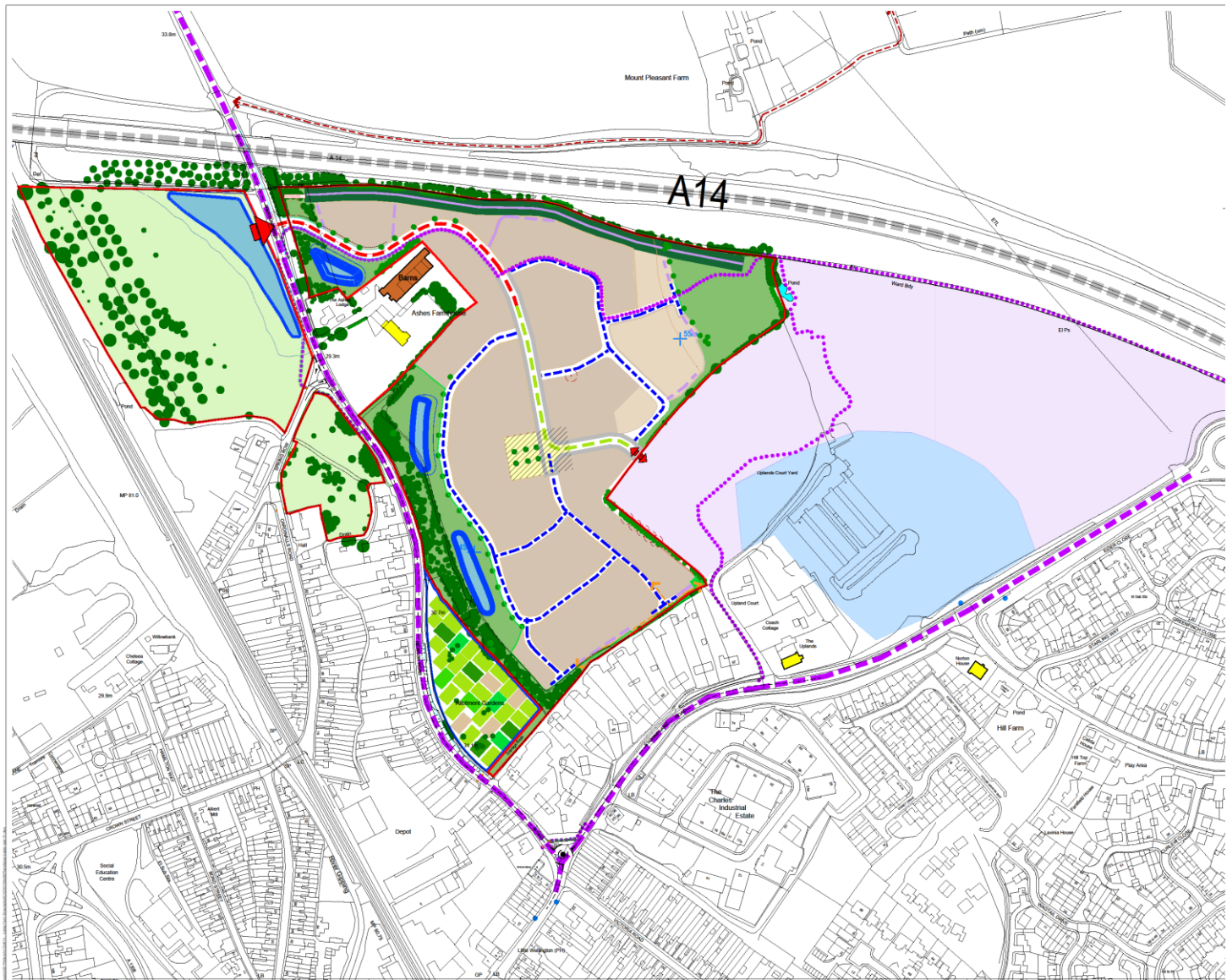























Zone 1 Concept Plan



- KEY**
-  Application Site Boundary
 -  Residential Area - Higher density
 -  Residential Area - lower density
 -  Vehicular Access Points
 -  2m bund with 2m noise fence
 -  Main Vehicle Access
 -  Secondary Vehicle Access
 -  Main Street
 -  Avenue
 -  Secondary Street Loop
 -  Shared Private Drive
 -  Local Squares
 -  Pedestrian Route Footpath Connection
 -  Pedestrian / Cycle Route Connection
 -  Designated Public Open Space
 -  Informal Open Space
 -  Existing Vegetation
 -  Proposed Trees
 -  Proposed Hedges
 -  Listed Buildings
 -  Indicative Attenuation Feature
 -  High Point / Low Point
 -  Bus Stop
 -  Allotments
 -  Development Concept Zone 2
 -  Development Concept Zone 3



Proposed Site Access

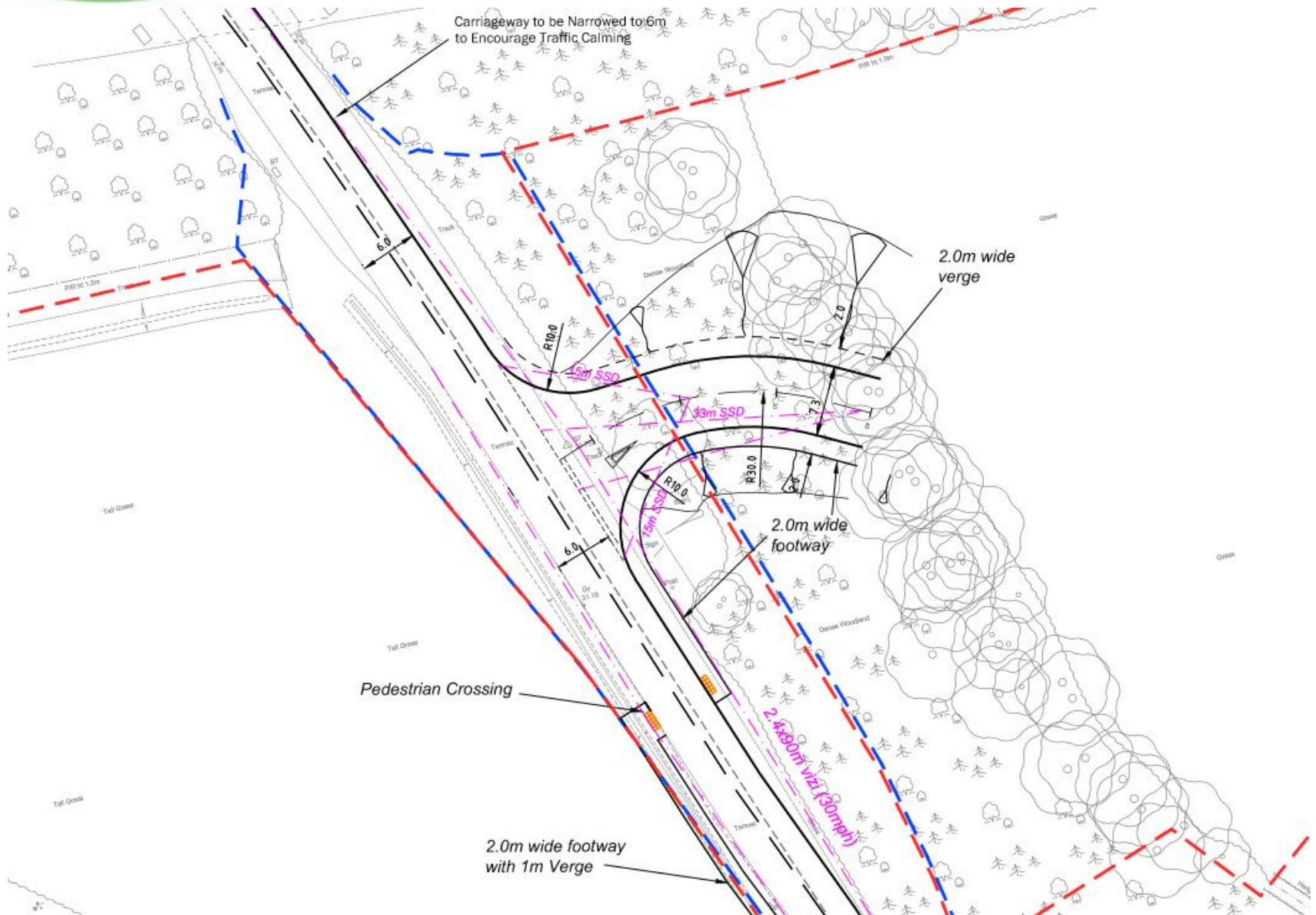

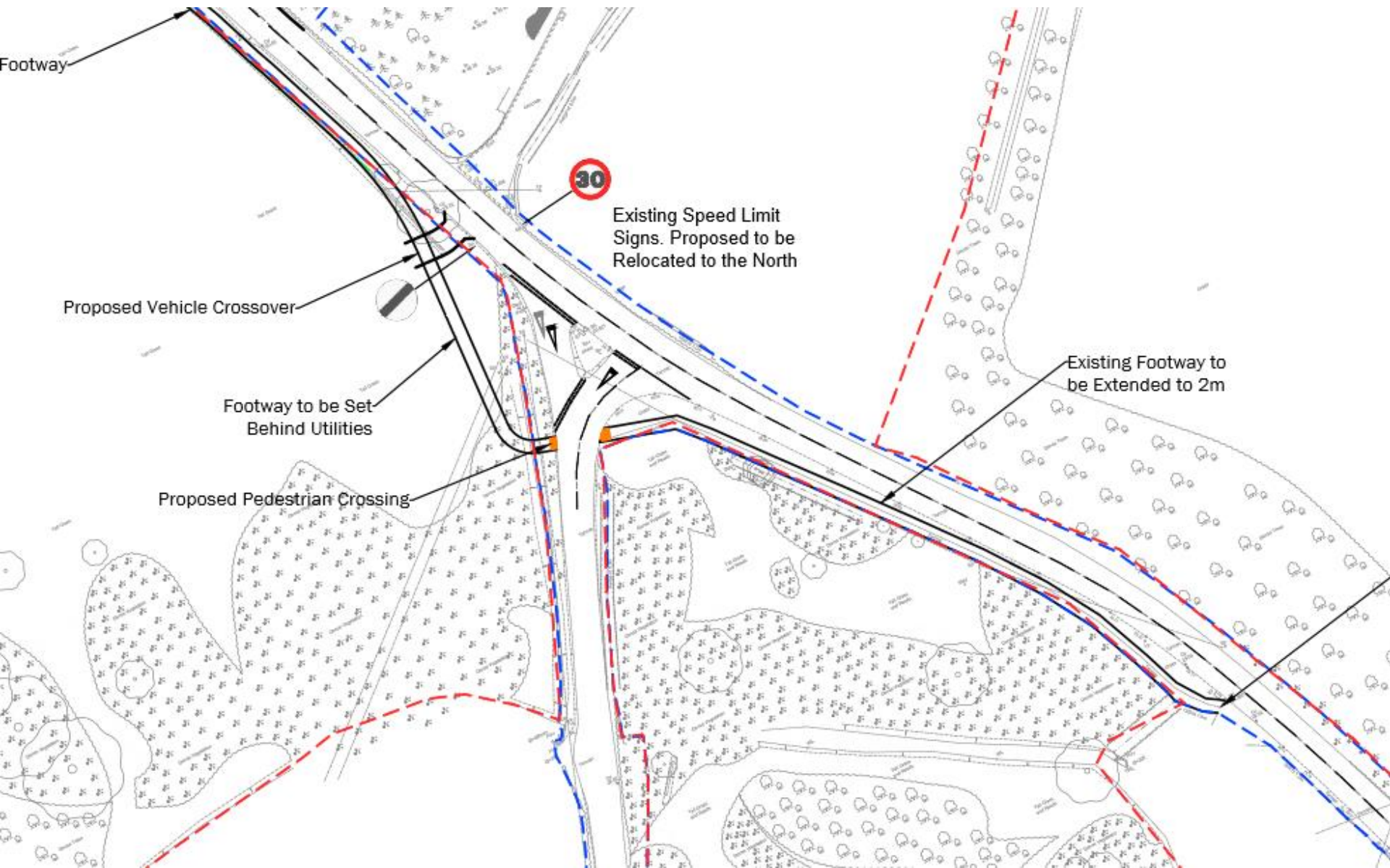

Proposed Newton Road/Stowupland Road highway works

Slide 12

